



Product Description

The light is fixed through an aperture in the bead head board which is held in place by a nut, secured from the back of the bed head. The light features a flexible stem to allow it to be positioned as required.

Metal finish

The light comes in the following metal finishes:

- Clear Anodised Aluminium
- Anodised Titanium
- Anodised Bronze
- Polished Nickel Plate
- Gold Plate

Leather finish

The light comes in the following leather finishes:

- Chocolate
- Beige
- Black
- Mushroom
- Off White

Dimensions

Depth/441mm
Bracket Depth/37mm

Electrical

The light uses 1.2 Watts of energy and requires a 12v DC power Supply.

The Zonda light is available in the following switching mode and LED colours.

- Warm White/High, Medium, Off
- Cool White/High, Medium, Off

Additional information

The Zonda Through the Bed light requires a driver for installing on a Mains voltage circuit. This driver should be installed remotely in a suitable area behind the fitting.

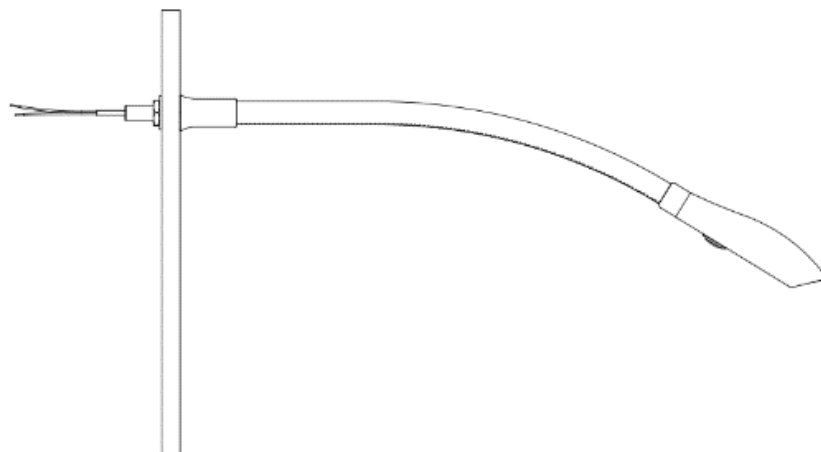

Light
Dimensions in mm

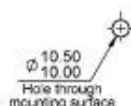

MOUNTING HOLE
Dimensions in mm